

PHOTOSYNTHESIS

By Jonathan Irawan SID 310213533

A city engulfed by its own cultural history, labelled through time as the “holy city”. You would think that such rich history would provide endless possibilities for design innovations but instead it limits how much we are able to change. It is a war-torn country with covert tensions between the various religions that reside in the area. In terms of infrastructure, the city has been centralised from the old city which has then spread and branched into the new city. Through this development strip displays the various contextual influences that have been taken into consideration, including the country's necessity in its infrastructure all the way to biomimicral influences in the form and function of the building. Similar to every city, country or town, values towards infrastructure relating to health, education and transport has been emphasised in the city. The growing number of mental health-related sickness such as “Jerusalem syndrome” has narrowed down these necessities into one option. This is how this project was born, these panels display how it has developed and grown into its own glory.

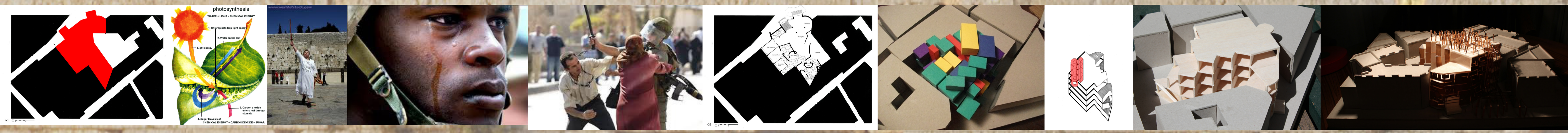
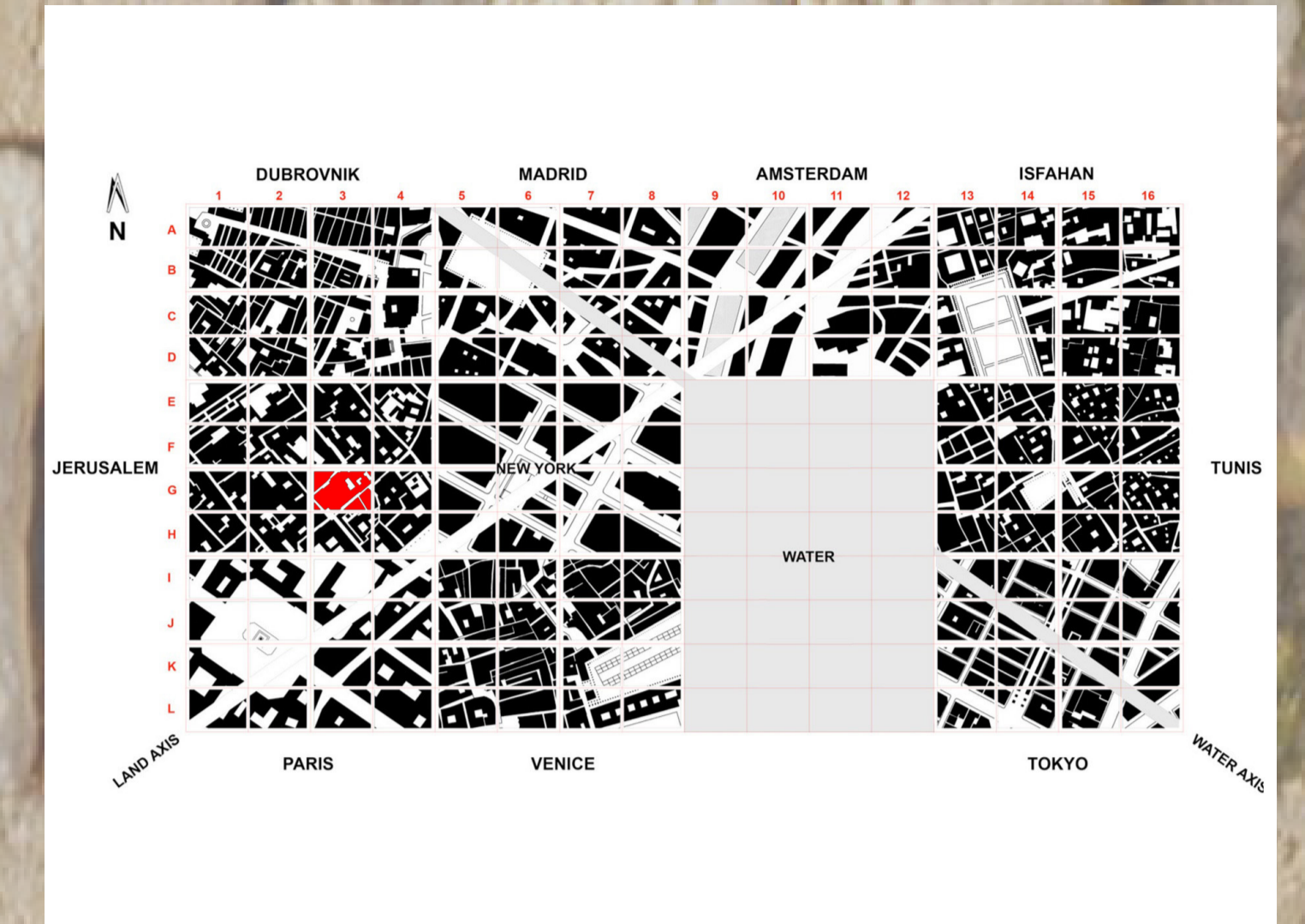

This project examines society's perception of the definition of any health institution. Health institutions today are designed to focus on the concept of sickness rather than healing. Due to society's gradual assimilation of this idea, we are forced to label or even base all designs of health institutions in order to have the idea embedded within people's minds. There is a specific atmosphere that is common between different health institutions which defines its function/brief/program. I wanted to explore the other side of this idea and focus on healing rather than sickness. In order to do this, I wanted spaces within the building to have maximum exposure to the sun. All the design decisions were based on this concept, whether it be orientation of room or the form of the entire building. Although I have altered the “box” like form of the health institutions, I still maintained uniformity and simplicity through the carving of patient rooms in each level for practical purposes. This also reinforces my aim to obtain maximum exposure to the sun. Patients should be encouraged to wander around these spaces and the implemented roof garden spaces. Combined with the contextual influences of Jerusalem, the proposed design should challenge society's current perception of the definition of a health institution and encourage them to explore possibilities through the birth of this project.

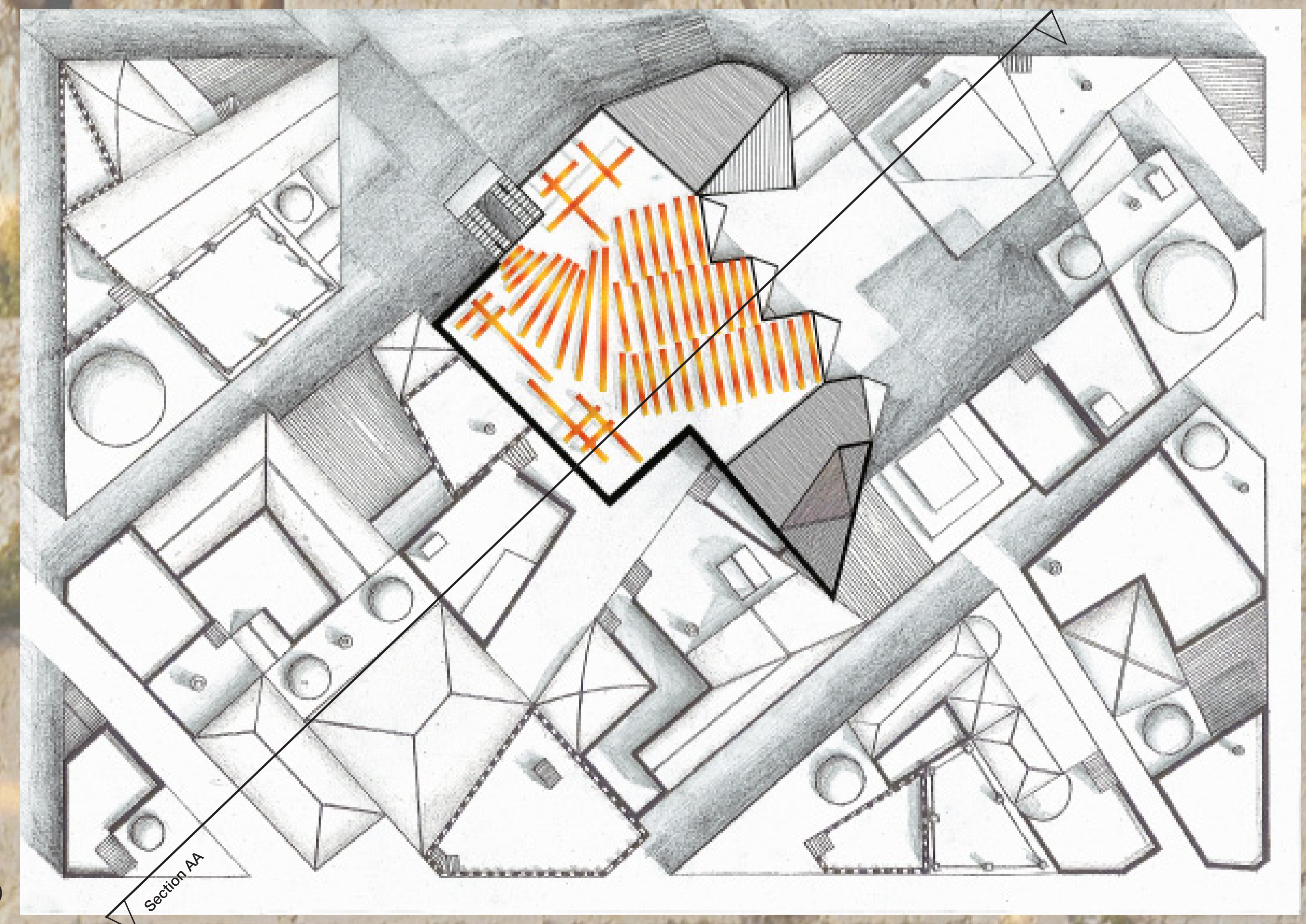

AERIAL PLAN 1:200

